

Deckendurchbruchsmasse

M= Zusätzliche 50 mm Freiraum für das Türblatt sind erforderlich.

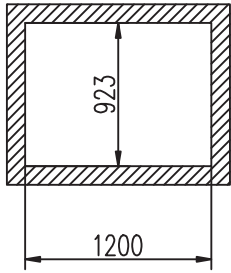

Shaft ceiling with LED spotlights

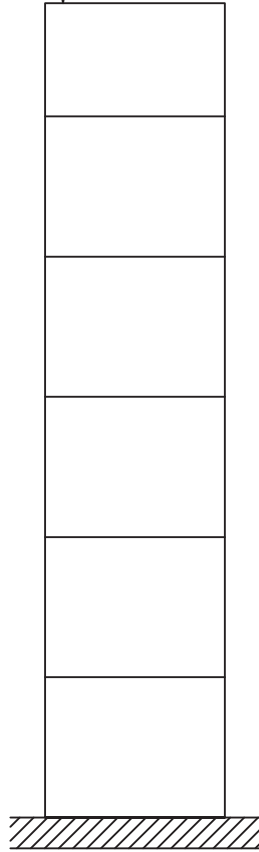

Seite C

Befestigungspunkte

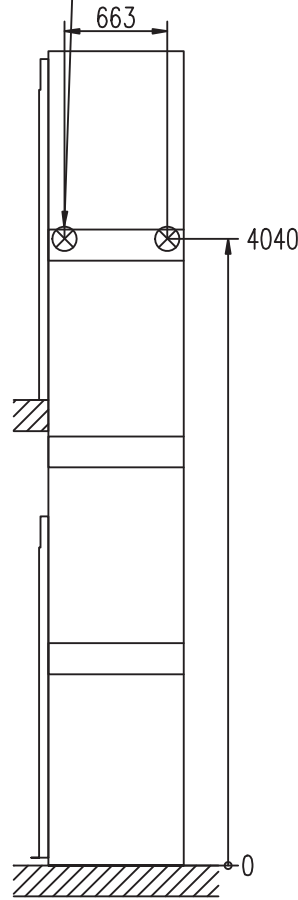

Seite D

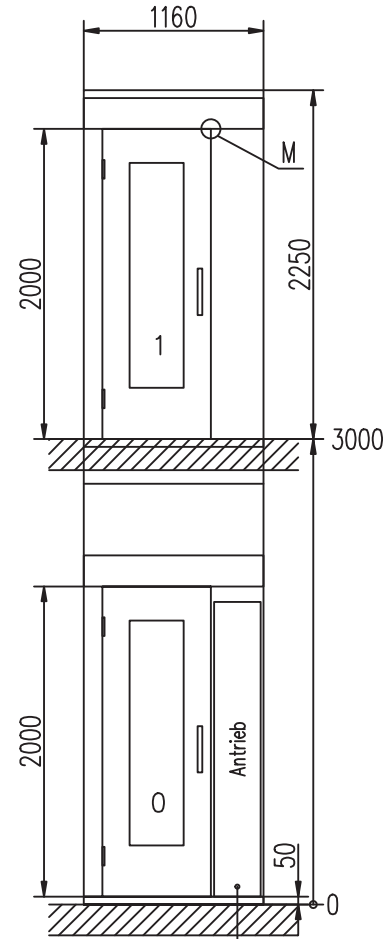

Seite A

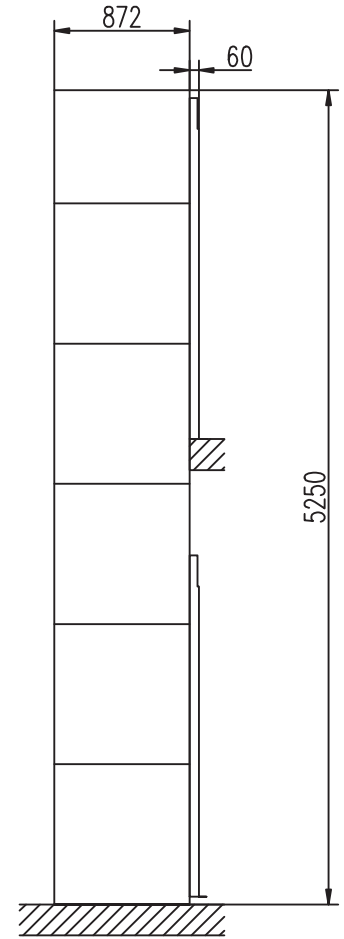

Seite B

Zugang zur Schaltschranktür erforderlich

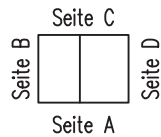
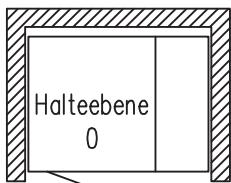
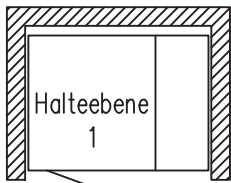

KTT GmbH

Elisabethstr. 16 a

32791 Lage

Telefon: 05232-9793800 | Fax: 05232-9793809

E-Mail: info@ktt.de | Web: www.ktt.de

• Treppenlifte • Senkrechtlifte • Plattformlifte • Hubbühnen

